

1. Dimensions of X and Y are dependent on the door thickness.
2. Strike is for use with 1" (25mm) throw deadbolt functions.
3. When using door silencers, strike location on frames must be adjusted to its thickness.

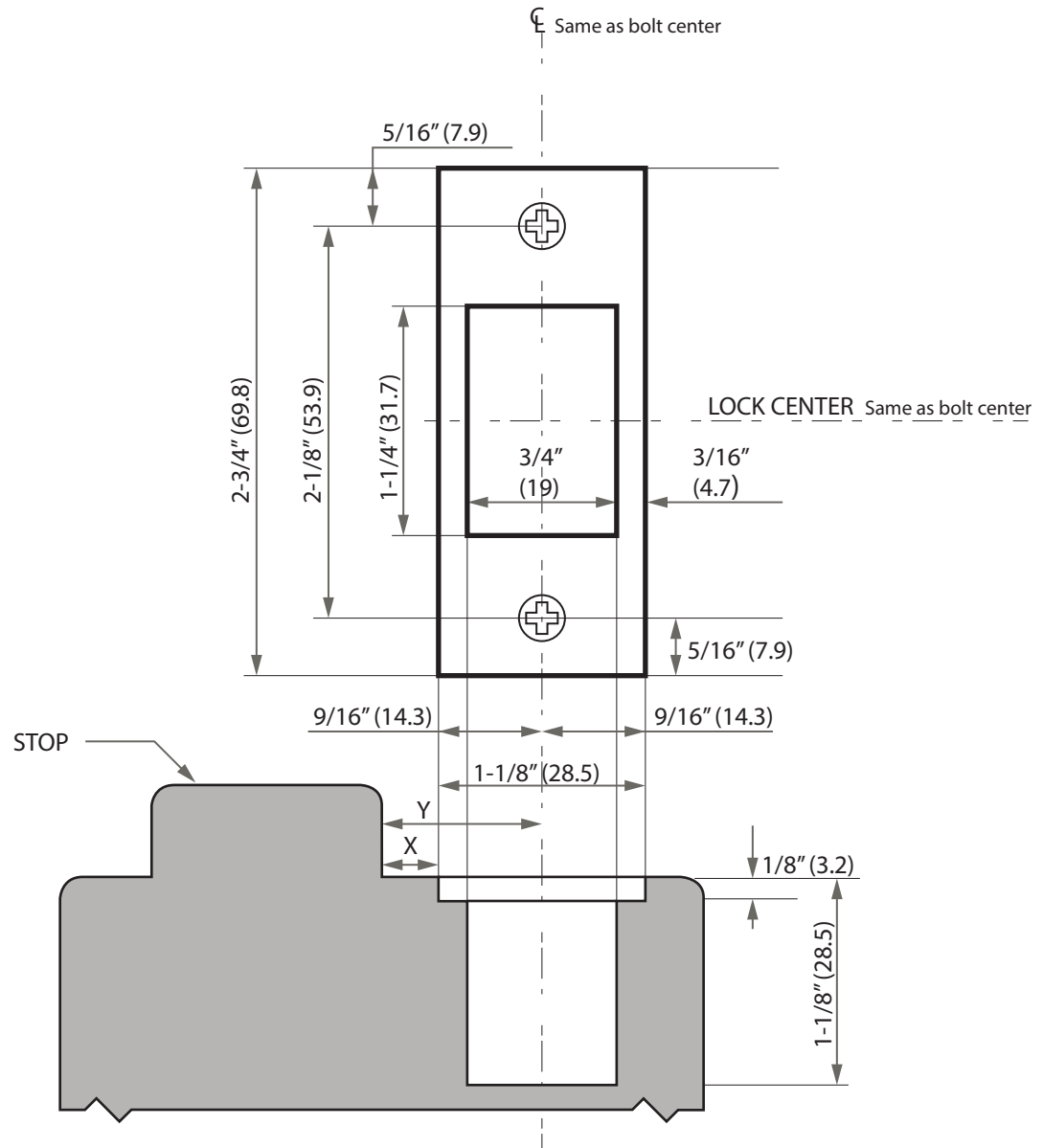

6605 Flotilla St.  
 City of Commerce  
 CA 90040 USA  
 Tel: (323) 888-6601  
 FAX: (323) 888-6699  
 Website: cal-royal.com  
 Email: sales@cal-royal.com

DESCRIPTION:

**DEADBOLT STRIKE FOR T220 DEADBOLT**  
**1-1/8" x 2-3/4"**

SCALE:

**1 : 1**  
 (IF PRINTED TO SIZE)

PAGE:

1 of 1

UNIT:

inches (mm)

VERSION:

ver.1.0 rev. 05/14

BY:

adg